

Operators Manual

Covers FP6 Series,
Field Pump, Camo Pump



FABARM
Pump Shotguns

SAFETY RULES

WARNING: READ THESE SAFETY RULES & OPERATORS MANUAL BEFORE HANDLING YOUR FIREARM. Learning how to use firearms safely is your responsibility as a shooter. Firearms can be dangerous and can cause serious injury, damage to property, or death, if handled improperly. To use your firearm correctly and safely, read and follow the instructions. Copies are available free on request from Heckler & Koch, Inc.

- Never point a firearm at anyone and always keep the muzzle pointed in a safe direction.
- Always treat all firearms as if they are loaded. Don't rely on your gun's "safety"
- Firearms should be unloaded when not in use and stored in a safe and secure location. . Keep firearms and ammunition away from children. Lock unloaded firearms and ammunition securely in separate locations.
- Be sure of your target and what's beyond it. Before you pull the trigger, make sure you can see the target clearly, and the path of the bullet, slug, or shot charge beyond the target. Never shoot at water, rocks, or any hard surface. Bullets, slugs, or shots may ricochet off such surfaces and cause injuries. Remember, shotgun pellets can travel 500 yards and shotgun slugs have a range of more than 1/2 mile. Centerfire bullets can travel up to 5 miles.
- Keep your finger off the trigger until your sights are on the target.
- Use correct ammunition. Only use ammunition that exactly matches the caliber or gauge markings on your firearm. Be sure the ammunition you are using is factory loaded and is not damaged in any way. Improperly made hand loads may cause the barrel or breech of a firearm to burst, which can result in serious personal injury or death.
- Never give to or take any firearm from anyone unless the action is open.
- Always wear ear and eye protection when shooting. Use shatterproof eyeglasses or shooting glasses when shooting. Wear proper hearing protection—repeated exposure to shooting noise can cause permanent hearing loss.
- Be sure the barrel is clear of obstructions. Before shooting, make certain the firearm is totally unloaded, on SAFE and the bolt locked to the rear. Check the bore of your unloaded shotgun for any possible obstructions.
- Never load your firearm until you are in a location where it is safe to shoot. Always keep the safety engaged until you are ready to shoot. As soon as you cease firing, even temporarily, you should immediately engage the safety.
- Keep your finger off the trigger while loading or unloading the shotgun.
- If your gun fails to fire, keep it pointed in a safe direction, then unload it carefully avoiding exposure to breech. If your gun fires, but the report or recoil seem weak, unload it and ensure the barrel is not obstructed.
- Don't alter or modify your gun. Do not make changes or alterations to any parts of your firearm. Use only genuine parts. Never make an adjustment to the trigger, or change the shape or size of the sear, sear notch, sear spring or any other internal parts.
- Clean and maintain the firearm according to the instructions in this booklet. Have the firearm checked periodically by a qualified gunsmith to make sure it is in good mechanical condition. Worn, damaged or missing parts may be dangerous.
- Learn your gun's mechanical and handling characteristics, Before firing any firearm unfamiliar to you, make sure you understand how it functions.
- Never handle any firearm when your ability is impaired by alcohol, any kind of drugs, illness or fatigue.
- Keep your firearm unloaded. Never carry or store a loaded firearm in a building or a vehicle. Unload your firearm before crossing or climbing up or down any obstacle that may prevent you from keeping full control over the firearm, such as a fallen tree, fence, tree stand, or slippery area.
- Discharging firearms in poorly ventilated areas, cleaning firearms, or handling ammunition may result in exposure to lead, a substance known to cause birth defects, reproductive harm, cancer and other serious physical injury. Have adequate ventilation at all times. Wash hands thoroughly after exposure.

FABARM Pump Shotgun Operators Manual

Covers FP6 Series, Field Pump, Camo Pump
(illustrations depict a Field Pump model)

Safety Rules	(opposite page)
Assembly.....	4
Function & Operation	4
Loading the Shotgun	5
Loading with the Bolt Closed	7
Shooting the Shotgun	8
Handling the Shotgun in the Field	9
Unloading	9
Disassembly	10
Maintenance & Cleaning	11
Lubrication	13
Reassembly.....	14
Bolt Disassembly/Reassembly	15
Removing/Installing Choke Tubes	16
Installing/Removing the Magazine Limiter Plug	17
Ammunition.....	17
Exploded Diagram & Parts List (FP6)	18-19
Exploded Diagram & Parts List (Field & Camo Pump)	20-21



© Heckler & Koch, Inc., 6/2002

All rights reserved

HK, Inc., 21480 Pacific Blvd.

Sterling, Virginia 20166-8903

United States of America

Telephone (703) 450-1900 • FAX (703) 450-8160 • www.hecklerkoch-usa.com

Specifications and models subject to change without notice.

Assembly

NOTE: Some FABARM Pump Shotguns are packed assembled and need only to have the packing preservative removed when received. Other FABARM Pump Shotguns are shipped disassembled with their barrels removed.

1. Before assembling, clean the barrel following the cleaning instructions.
2. Move the forend in the forward position and unscrew and remove the forend cap.
3. Position the barrel above the magazine tube and align the breech end of the barrel to fit into the shotgun receiver.
4. Carefully slide the barrel rearward into the receiver. The breech (rear) end of the barrel should fit between the receiver and the bolt (see shotgun reassembly section on page 14).
5. Continue to slide the barrel rearward until the barrel guide ring fits over the magazine tube.
6. Replace and tighten the forend cap.

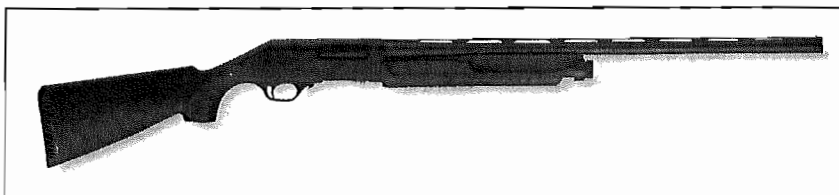

(figure 1) Field Pump Model

NOTE: The illustrations in this manual depict the Field Pump model, operation and maintenance of other FABARM Pump-action shotguns is essentially the same.

Function and Operation

FABARM pump-action shotguns are designed for a variety of sporting, law enforcement, and utilitarian uses. FABARM pump-action shotguns are capable of holding five shells in the magazine tube and one in the chamber. For hunting use, with a limiter plug installed, the magazine capacity drops to two and one in the chamber. A magazine extension is also available for security and law enforcement applications.

The forend is attached to the bolt by way of the action bars. As the forend is pulled rearward a camming surface on the action bar contacts the shell latch and moves it out of the path of the shells in the magazine tube. This releases a shell onto the carrier while the next round in the magazine falls to the cartridge retaining latch and is stopped.

NOTE: The long style forend also has threaded hard points for mounting accessories with an optional Picatinny rail.

As the action bars move forward pushing the bolt and the cartridge that was on the carrier into the chamber, the cartridge retaining latch is moved out of the way allowing the next

round in the magazine to fall to the shell latch. As the bolt reaches its fully seated position, the action bars move forward in the bolt forcing the locking bolt into the recess in the top of the barrel extension.

This causes the action to lock into battery. By pulling the trigger the shotgun fires and the slide unhooking lever is activated. The forend and action bars are allowed to move to the rear extracting and ejecting the empty hull while cocking the hammer back and releasing another shell from the magazine tube.

Loading the Shotgun

1. Point the firearm in a safe direction.

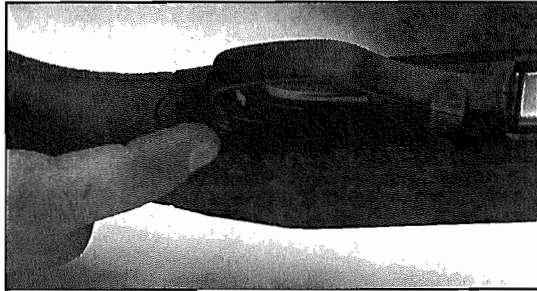

(figure 2) Safety being engaged

2. Put the safety on SAFE by pushing the safety button on the side where the red stripe is seen. Push until the Safety snaps into position and the red stripe has disappeared. For a right handed shooter this would mean pushing the safety from left to right.

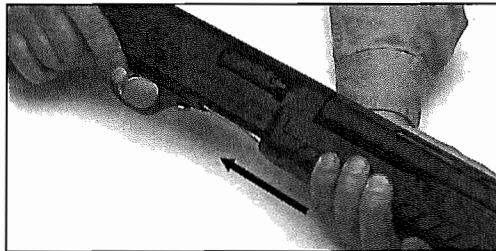

(figure 3)

3. Pull the forend back until the bolt locks open (see figure 3 above). Do not pull the trigger to release the forearm, instead use the forearm release button (also referred to as the slide unhooking lever) located in front of the trigger guard.

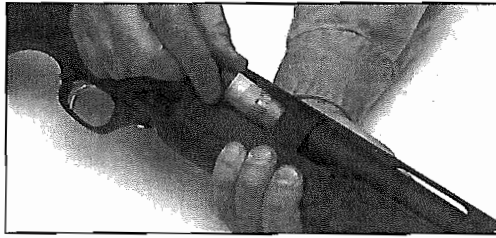

(figure 4)

4. Place a shell in the receiver through the ejection port crimped end forward (see figure 4 above).

WARNING: Ensure you are using correct ammunition. Only use ammunition that exactly matches the gauge markings on your shotgun. It is strongly recommended that only factory loaded ammunition be used. Careless or incorrect handloading is dangerous. Improperly made handloads may cause severe damage to the shotgun and can result in serious injury or death. Damage caused by improper ammunition is not covered by the warranty.

5. To chamber the shell push the forend forward. This will close the bolt chambering the shell in the process (see figure 5 below).

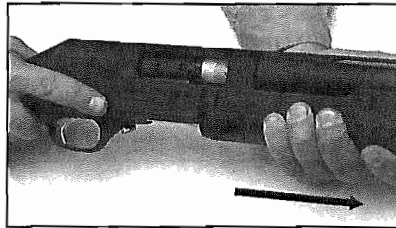

(figure 5)

6. Hold the shotgun upside down, cradling the top of the receiver in the palm of your left hand. Insert the shells with your right hand by pressing the carrier down using the crimped end of the shell which gives you access to the magazine spring follower.

NOTE: Left handed shooters will normally reverse the hand instructions above.

Push the shell forward into the magazine tube until the shell latch snaps into place to hold the shell. Repeat until the shotgun is fully loaded. (see figure 6a & b)

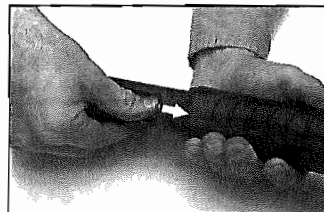
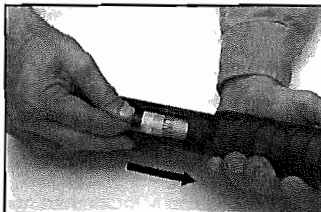

(figure 6a & b) Loading the magazine tube

WARNING: The shotgun is ready to fire. Keep your finger off the trigger and out of the trigger guard until you are ready to fire the shotgun (see figure 7)

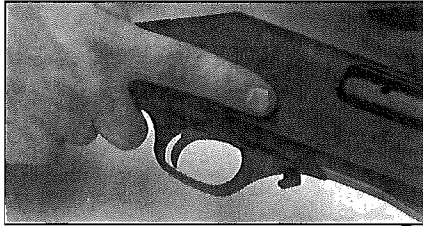

(figure 7)

Take the shotgun off **SAFE** by pushing the Safety off with the index finger of the shooting hand (figure 8 below).

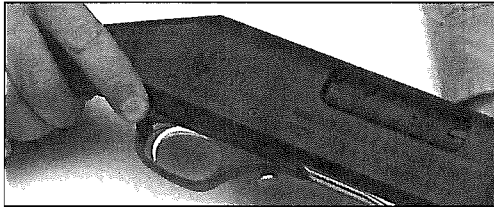

(figure 8) Safety being disengaged

With the gun loaded and the Safety OFF, the gun is ready to fire.

Loading with the Bolt Closed (Loading the Magazine)

1. Place the safety in the safe position as described in the previous section.
2. Turn the gun upside down as before and push the carrier down with the crimped end of the shell until you have access to the magazine spring follower (see figure 9) .

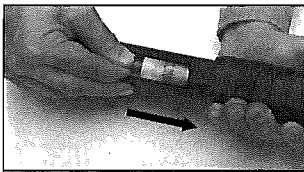

(figure 9)

Push the shell forward with your thumb until the shell latch snaps behind it.

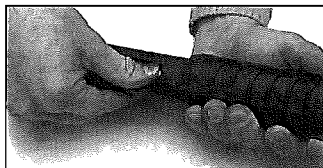

(figure 10)

Repeat until the magazine tube is full.

3. To chamber a round, point the gun in a safe direction, finger out of the trigger guard and the safety ON, press up on the forearm release button (slide unhooking lever) located in front of the trigger guard and pull the forend all the way to the rear. This will release a round from the magazine tube to the carrier where it can be pushed into the chamber with the bolt. Push the forend forward with enough force to lock the bolt closed after chambering the round (figure 11 below).

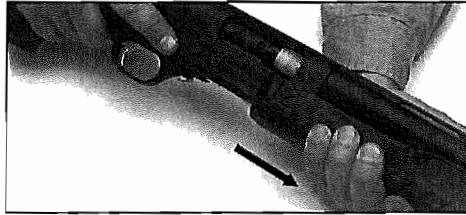

(figure 11)

WARNING: The shotgun is ready to fire. Keep your finger out of the trigger guard until you are ready to fire the shotgun.

4. Turn the gun upside down and insert one more shell in the magazine tube to fill the gun (as in step 2 of this section).
5. To fire the gun, place the safety in a position where the red stripe is visible. The gun is now ready to fire.

Shooting the Shotgun

1. Keeping your finger out of the trigger guard, place the gun in your shoulder in the pocket formed by your upper arm and shoulder when you lift your upper arm and reach forward.
2. Hold the gun firmly in your shoulder, but not so tightly that you are straining. Hold the pistol grip firmly, as you would when shaking hands, keeping the trigger finger extended along side the bottom of the receiver until you are ready to take the safety OFF (figure 12 below).

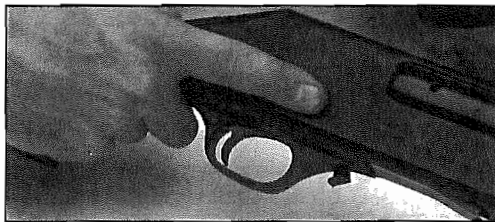

(figure 12)

3. Place your cheek firmly on the comb (top) of the stock. It is proper to bring the gun up to your cheek, not to force your cheek down onto the stock.

NOTE: Most of the strength required to hold the gun up should come from your shooting hand. The non-shooting hand is used primarily to balance and swing the front of the gun during shooting.

4. Pull the trigger to fire the shotgun. Keep your cheek firmly on the stock during recoil. Lifting your cheek can cause you to miss your target or to be subject to much harsher recoil than necessary.
5. After firing, place the shotgun safety ON immediately!

Handling the Shotgun in the Field

1. If it becomes necessary to cross a fence, climb, cross a road etc., the shotgun can be rendered safe without removing all the shells in the magazine. Put the safety in the SAFE position and point the shotgun in a safe direction.
2. Holding the forend with your non-firing hand use the index finger of the firing hand to depress the forearm release button and pull the forend to the rear, catching the ejected shell with your firing hand. With the bolt open the carrier can be depressed and the shell latch activated from inside the receiver with your finger. This releases a shell from the magazine. Repeat until all rounds are out of the magazine.
3. With the bolt held open, and no shells in the magazine tube, the gun is clear.
4. Once the requirement for the unloaded shotgun is past, the gun can be easily reloaded by placing the shell back in the receiver and reloading the magazine as before.

Unloading

1. Place the safety in the safe position and point the gun in a safe direction.
2. Turn the gun upside down and depress the carrier with your index finger.
3. Press on the shell latch from inside the bottom of the receiver and release the shells from the magazine tube (figure 13 below).

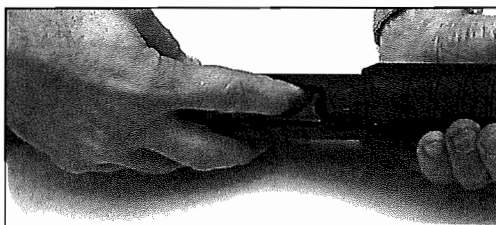

(figure 13)
Shell latch being activated by hand

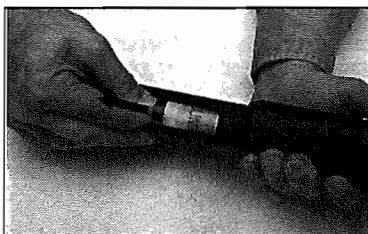

(figure 14) Shell being removed from the magazine tube

4. To unload the chamber, lift up on the forearm release button which will unlock the action and the forend can be pulled to the rear extracting and ejecting the round in the chamber. This should be done slowly to enable you to catch the round as it leaves the gun (figure 15).



(figure 15)

Disassembly

1. Place the shotgun on safe and ensure that it is completely unloaded. With the bolt closed, unscrew the forend cap (figure 16) and slide off the barrel (figure 17).

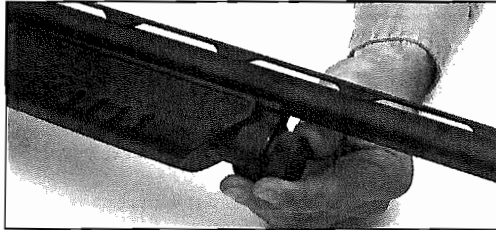

(figure 16)

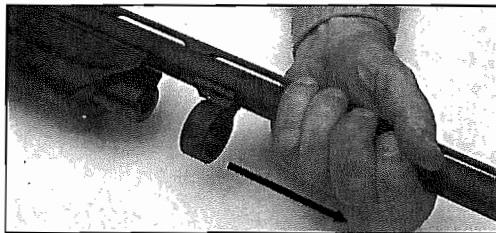

(figure 17)

2. Push the forend forward to remove the forend, action bars and bolt.
3. Lifting the bolt will separate the bolt from the action bars.

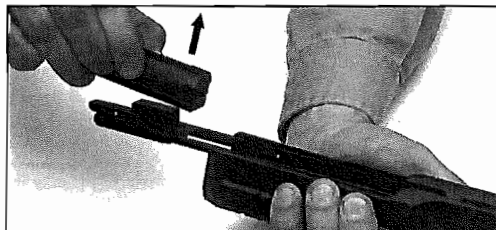

(figure 18)

4. With a pin punch tap out the two trigger guard pins (figure 19 below).

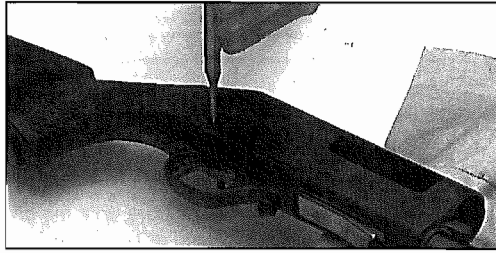

(figure 19)



(figure 20)

5. Remove the trigger assembly (see figure 20 above).

NOTE: The shotgun is now disassembled as far as is recommended for normal maintenance and cleaning!

Maintenance and Cleaning

The proper maintenance and cleaning of your shotgun will enhance the performance and extend the service life of your FABARM shotgun.

Recommended cleaning items and their uses:

- Rags for wiping - may be cloth or paper, but not polyester, nylon, rayon etc. as they are not absorbent.
- Cleaning patches - for the bore of the barrel
- Bore cleaning brushes - phosphor bronze, brass, nylon are best, stainless steel only as a "Tornado" style brush
- Cleaning rod
- Cleaning solvent, general purpose - many good ones on the market, many new ones are biodegradable and not hazardous. Check with your local gun shop on the availability of these cleaners. **NEVER USE GASOLINE!** It is extremely hazardous!
- Bore cleaning solvents - again, many good ones on the market, look for a solvents ability to remove lead and copper from a bore. Should be non-abrasive.

For cleaning the stock and forend of any shotgun with polymer stocks soap and water will suffice. With the shotgun disassembled as in the previous section attention should be paid to each group of the gun.

NOTE: After each use, follow the recommended lubrication and maintenance directions.

Barrel

1. Wet a patch with bore cleaning solvent and wet the inside of the bore by pushing the wet patch through from the chamber end of the barrel. Let this soak while you attend to another part such as the bolt and action bars.
2. Change the patch holder for a brush and brush the bore from the chamber end full strokes from one end to the other without changing direction while the brush is still in the barrel. Brush 5 to 10 full cycles (1 cycle = one stroke in and one stroke out).

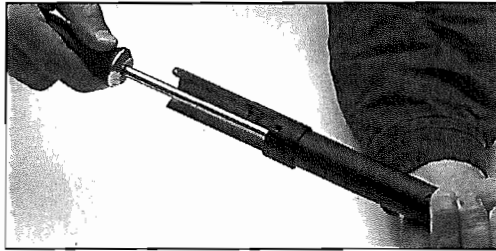

(figure 21)

3. Change back to the patch holder and run patches through the bore from the rear until the patch emerges from the barrel clean (figure 21 above). Wet a new patch with a lubricant/ preservative and LIGHTLY coat the bore. (The bore is chrome lined and impervious to normal corrosion, but if left unprotected some acids found in shot shell residue could lead to corrosion.)

WARNING: After cleaning, make sure the barrel is free of obstructions.

4. Carefully wipe the outside of the barrel to remove any moisture, dirt, carbon, or other residue from the exterior metal finish. The outside of the barrel should be covered by a good quality preservative to protect the finish. Rust can and will occur if this is neglected is NOT covered by the warranty.

Finger prints are especially prone to rust as the acids in the oils of the skin are very corrosive. Always wipe fingerprints off the metal portions of a firearm to prevent rust. Specially treated cloths are available to perform this acid neutralizing step as you wipe the gun.

Bolt and Action Bars

1. The bolt and the action bars should be cleaned thoroughly with a general purpose solvent and a bristle brush.
2. Each of these parts should be lightly coated with oil to prevent rusting and corrosion.

Trigger Group

The trigger group should be washed in general purpose solvent and allowed to air dry or blown dry with compressed air.

CAUTION: Use safety goggles when using solvents and exercise care if using compressed air. Ensure the cleaning area is well ventilated. Avoid getting spray in your eyes or breathing vapors.

Stock, Receiver, and Forend Group

1. The receiver should have any residue / carbon / dirt removed with a soft bristle brush and general purpose solvent. Care should be taken to keep the solvent off the stock and forend while cleaning the receiver. Additionally care must be taken to avoid getting excess solvent runoff in the magazine tube. Air dry the receiver or blow dry it with compressed air, exercising the same cautions written in the Trigger Group Section.
2. If the stock and forend has dirt / debris on it, this should be cleaned as soon as possible. Make sure the cloth is damp, not wet to the point of leaving water on the stock.

CAUTION: Do not use solvents or cleaning agents that indicate that they could soften or melt plastics or polymer.

Lubrication

Avoid over-lubrication. A thin coat of a quality gun oil will help prevent rust. When storing the firearm it should be carefully cleaned and oiled. Outside surfaces should be wiped with a thin coat of quality gun oil occasionally. When the firearm is to be reused, remove all excess lubrication. Ensure the chamber and the inside of the barrel are free of excess oil.

Listed below are some specific areas and their lubrication requirements. Extra attention to these areas to make certain oil is present is recommended.

WARNING: After each use, follow the lubrication and maintenance directions in this instruction book. If the firearm is immersed in water, it should be thoroughly cleaned and lubricated as soon as possible. In case of salt water immersion, first flush all parts with fresh water, then dry, clean and lubricate the firearm. If the firearm does not function properly, have it examined by a competent gunsmith before further use. Failure to follow this warning may lead to malfunctions which could result in serious personal injuries.

1. Barrel/Choke Tubes - there are no specific lubrication points on the barrel of the shotgun. Lubricate only as a thin film over the entire barrel to prevent rust. A thin film of lubricate will also help protect the choke tubes.
2. Trigger Group - General lubrication throughout to prevent rust with extra on the hammer pin and each pivot point in the mechanism.
3. Receiver - Lubricate the inside of the receiver with extra lubricant on the rails where the bolt rides.
4. Bolt Group - General overall lubrication. Extra lubricant on the rails of the bolt where it rides in the receiver, and on the inside of the action bar sleeve in the front of the action bar assembly.

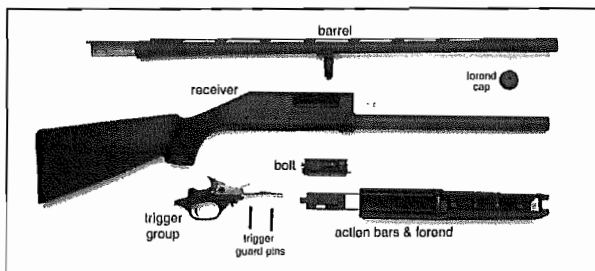

(figure 22)

Reassembly

1. Make certain the hammer is cocked, then reinstall the trigger guard assembly (figure 23) and install the two trigger guard retaining pins.



(figure 23)

2. Place the bolt assembly on the end of action bar, don't forget to put the locking bolt in position first. Ensure the bolt is sitting flush, not angled up.

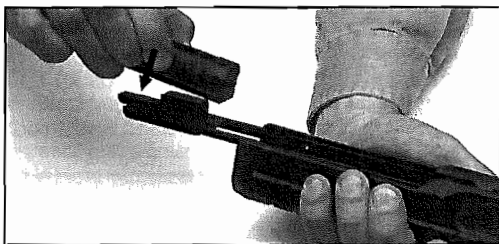

(figure 24)

3. Guide the assembly into the tracks on both sides of the receiver (see figure 25).

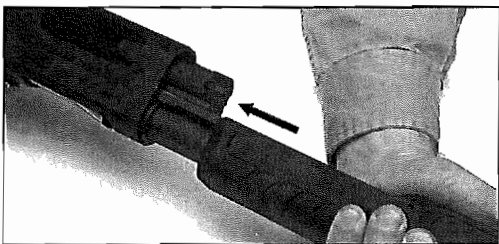

(figure 25) Bolt assembly being reinstalled into the receiver

4. Making sure the bolt is forward, install the barrel and screw on the forend cap (figures 26 and 27).

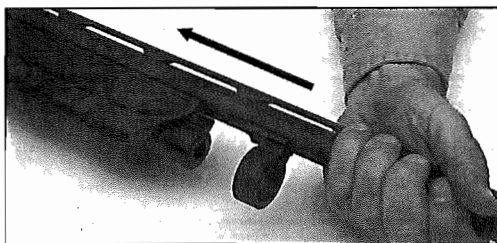

(figure 26) Barrel being installed

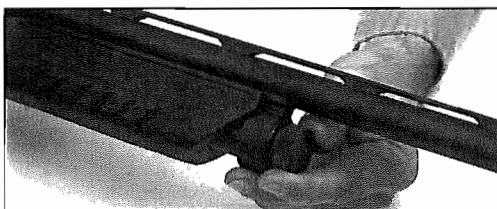

(figure 27) Forend cap being tightened

5. Place the gun on safe.

Bolt Disassembly/Reassembly

To disassemble the bolt (firing pin and locking block)

1. Push the rear of the firing pin forward slightly and remove the firing pin stop (part G12) by pushing it down through the bottom of the bolt.
2. Release pressure on the firing pin and remove it from the back of the bolt. Remove the firing pin spring from the back of the bolt.
3. Remove the locking block (part G02) by lifting its front end up and unhooking it. It removes from the top of the bolt.
4. It is not necessary to remove the extractor assembly.

To reassemble the bolt:

1. Hold the bolt right side up. Hook the rear of the locking block through the top of the bolt into its recess at the rear of the bolt and let the front of the locking block rest in the unlocked position.
2. Install the firing pin spring onto the firing pin. Take the bolt and turn it upside down, while preventing the locking block from falling out of place. The back of the firing pin has a notch cutout. This cutout must face toward the hole in the bolt for the firing pin stop. Push the firing pin assembly in from the rear of the bolt until the notch in the firing pin is aligned with the firing pin stop hole, allowing the firing pin stop to be installed. Hold the firing pin in this position while installing the firing pin stop from the bottom of the bolt. Push in the firing pin stop until it is flush with the bottom of the bolt.

NOTE 1: When handling the bolt, be careful to avoid unintentionally pushing in on the rear of the firing pin, as the firing pin stop may drop free.

NOTE 2: A hole in bolt body allows confirmation of the presence of the locking block.

Removing/Installing Choke Tubes

WARNING: Unload the firearm before changing choke tubes. Leave the action open and the chamber and magazine empty when changing choke tubes

1. Point the shotgun in a safe direction.
2. Engage the safety switch. Make sure the RED BAND IS NOT SHOWING.
3. Place the choke tube wrench into the choke tube.

NOTE: On FP6 models the wrench fits around the outside of the choke tube.

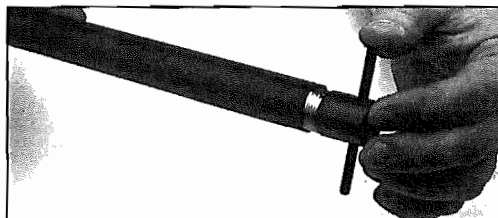

(figure 28) Choke tube being reinstalled into the barrel

4. Turn the wrench counter-clockwise to remove the choke tube.
5. Select the desired choke tube and insert the tube into the barrel.
6. Using the choke tube wrench, tighten the choke tube snugly into the barrel but **DO NOT OVER TIGHTEN**.
7. With the action open and the chamber and magazine empty, check the choke tube occasionally to make sure the tube has not loosened.

Choke Tube Markings		
FULL (lead only)	*	1 notch
I.M. (lead only)	**	2 notches
MOD	***	3 notches
I.C.	****	4 notches
CYL SKEET		0 notches

(figure 29) Choke tube marking guide

NOTE: Steel shot should only be used in "steel shot-approved" choke tubes and in Cylinder, Skeet, and Improved Cylinder chokes.



(figure 30a)
innerchoke
FIELD ONLY



(figure 30b)
competition
FIELD ONLY



(figure 30c)
in-out choke
FIELD ONLY



(figure 30d)
FP6 multichoke



(figure 30e)
FP6 thread cap

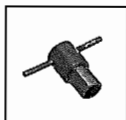

(figure 31a) choke wrench for Field Pump



(figure 31b) choke wrench for FP6

CAUTION: Never fire the shotgun without a choke tube installed.

Installing/Removing the Magazine Limiter Plug

NOTE: A magazine plug which limits the magazine capacity to two (2) shells must be installed according to The Federal Migratory Bird Act and most state hunting laws.

To install the magazine plug on shotguns having magazine spring retainers with a button hole in the magazine spring retainer:

1. Engage the safety switch. RED BAND WILL NOT SHOW.
2. Check the chamber and the magazine to make sure there are no shells in the shotgun.
3. Unscrew and remove the forend cap.
4. Put a screwdriver into the open end of the magazine tube. Move the tip under the rim of the magazine spring retainer.
5. Place your hand over the end of the magazine tube.
6. Use the screw driver, pry up and remove the magazine spring retainer.

WARNING: Use extreme care when removing the magazine spring retainer, as the retainer is under tension from the magazine spring.

7. Place the small end of the magazine plug into the magazine spring.
8. Put the magazine spring retainer over the large end of the magazine plug.
9. Push the magazine spring, magazine plug and magazine retainer into the magazine tube.
10. With a soft mallet, tap the magazine spring retainer into the magazine tube, even to the end of the magazine tube.
11. Replace and tighten the forend cap.

Ammunition

Only factory loaded 12 gauge, 2 $\frac{3}{4}$ inch or 3 inch shells should be used in these shotguns. Use of reloaded, re-manufactured, or handloaded ammunition is not recommended and may void the warranty.

WARNING: Never use cartridges longer than those designed for the shotgun. (Shells marked 3 inches are only 2 $\frac{3}{4}$ inches before firing.) The size of the chamber indicates the length of a fired shell. DO NOT fire a shell longer than 3 inches in the chamber regardless of the shell fitting prior to firing. Damage to the gun and possible injury or death to the shooter could occur.

For More Information

Contact Heckler & Koch Customer Service at (703) 450-1900, 21480 Pacific Boulevard, Sterling, Virginia 20166.

HW40 01296 (rev04) 12/15/01

Fp6 Diagram & Parts List

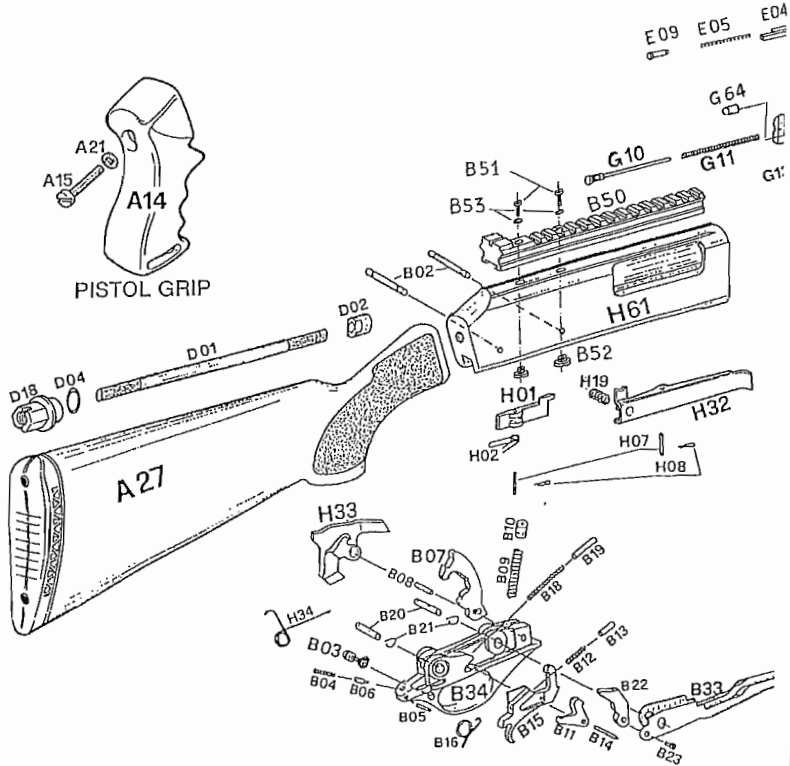

Fabarm Part #	HK Part #	Description
A14	A1400	pump pistol grip
A15	A1500	connecting rod or pump pistol grip
A21	A2100	bolt cap pistol grip
A27	A2700	pump plastic stock
A31	A3100	pivot pin for folding stock
A32	A3200	recoil pad for folding stock
A33	A3300	frame for folding stock
A34	A3400	pistol grip for folding stock
A35	A3500	frame bracket for folding stock
A36	A3600	positioning pin for folding stock
A37	A3700	folding stock spring
A38	A3800	pivot pin anticrewing screw
A39	A3800	folding stock rubber recoil pad screw
A42	A4200	folding stock complete
B02	B0200	trigger guard retaining pin
B03	B0300	hand safety button
B04	B0400	hand safety spring
B05	B0500	hand safety spring pin
B06	B0600	hand safety spring plunger

Fabarm Part #	HK Part #	Description
B07	B0700	hammer
B08	B0800	hammer pin
B09	B0900	hammer spring
B10	B1000	hammer spring follower
B11	B1100	sear
B12	B1200	sear spring
B13	B1300	sear spring follower
B14	B1400	trigger and sear pin
B15	B1500	trigger
B16	B1600	trigger spring
B18	B1800	carrier spring
B19	B1900	carrier spring guide
B20	B2000	trigger guard pin bushing
B21	B2100	trigger guard pin spring
B22	B2200	carrier dog
B23	B2300	carrier dog pin
B33	B3300	carrier
B34	B3400	trigger guard
B50	B5000	Picatinny rail

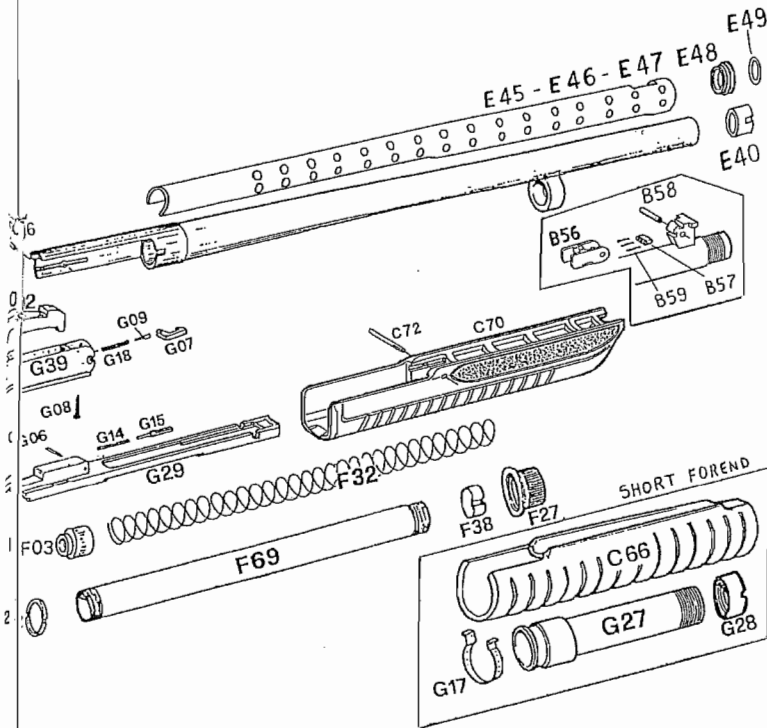

Fabarm Part #	HK Part #	Description
B51	B5100	Picatinny retaining screw
B52	B5200	nut retaining screw
B53	B5300	elastic washer
B56	B5600	folding sight
B57	B5700	folding sight spring washer
B58	B5800	folding sight elastic pin
B59	B5900	folding sight spring
C66	C6600	pump plastic forend
C70	C7000	long forend
C72	C7200	elastic forend pin
D01	D0100	stock connecting rod
D02	D0200	stock bolt cap
D04	D0400	stock washer
D18	D1800	stock & balancer retaining screw
E04	E0400	mobile ejector lever
E05	E0500	ejector lever spring
E06	E0600	ejector lever retaining pin
E09	E0900	ejector lever spring follower
E40	E4000	barrel retaining washer
E45	E4500	heat shield 20 in. for folding sight
E46	E4600	heat shield 14 in. for folding sight
E47	E4700	heat shield 20 in. for fixed sight
E48	E4800	heat shield retaining cap
E49	E4900	o-ring retaining heatshield
F02	F0200	magazine tube washer
F03	F0300	magazine follower
F27	F2700	forend cap
F32	F2000	magazine spring
F38	F3800	magazine spring retaining ring
F69	F6900	magazine tube
G02	G0200	locking bolt
G06	G0600	cocking handle plunger pin
G07	G0700	extractor
G08	G0800	extractor retaining pin
G09	G0900	extractor plunger
G10	G1000	firing pin
G11	G1100	firing pin spring

Fabarm Part #	HK Part #	Description
G12	G1200	firing pin stop
G14	G1400	bolt slide spring
G15	G1500	bolt slide spring guide
G17	G1700	sleeve snap ring
G18	G1800	extractor spring
G27	G2700	action bar sleeve
G28	G2800	forend retaining washer
G29	G2900	action bar
G39	G3900	breech bolt for pump
G64	G6400	breech bolt absorber
H01	H0100	magazine shell latch
H02	H0200	magazine shell latch spring
H07	H0700	latch pin
H08	H0800	latch pin spring
H19	H1900	carrier latch spring
H32	H3200	cartridge retaining latch
H33	H3300	slide unhooking lever (forearm release button)
H34	H3400	slide unhooking lever spring
H61	H6100	receiver for pump
	219662	long Picatinny rail for forearm
	B0047A	ghost-ring rear sight (for B50 / B5000)
	701793	folding stock (Choate Machine & Tool)
	701792	4 shot magazine extension (CM&T)
	I1017	full choke
	I1019	modified choke
	I1020	improved cylinder choke
	I1018	improved modified choke
	I1021	choke wrench
	F2000HS	20" barrel with heat shield (HS) and flip-up front (FF) sight
	F2000CF	20" barrel with heat shield (HS) and carbon fiber (CF) finish
	F1400CF	14" barrel with heat shield (HS) and carbon fiber (CF) finish
	F20CFHS	20" barrel with heat shield (HS), flip-up front (FF) sight & carbon fiber (CF) finish

NOTE: Not all parts depicted in diagram

Exploded Diagram & Parts List (Field & Camo Pump)

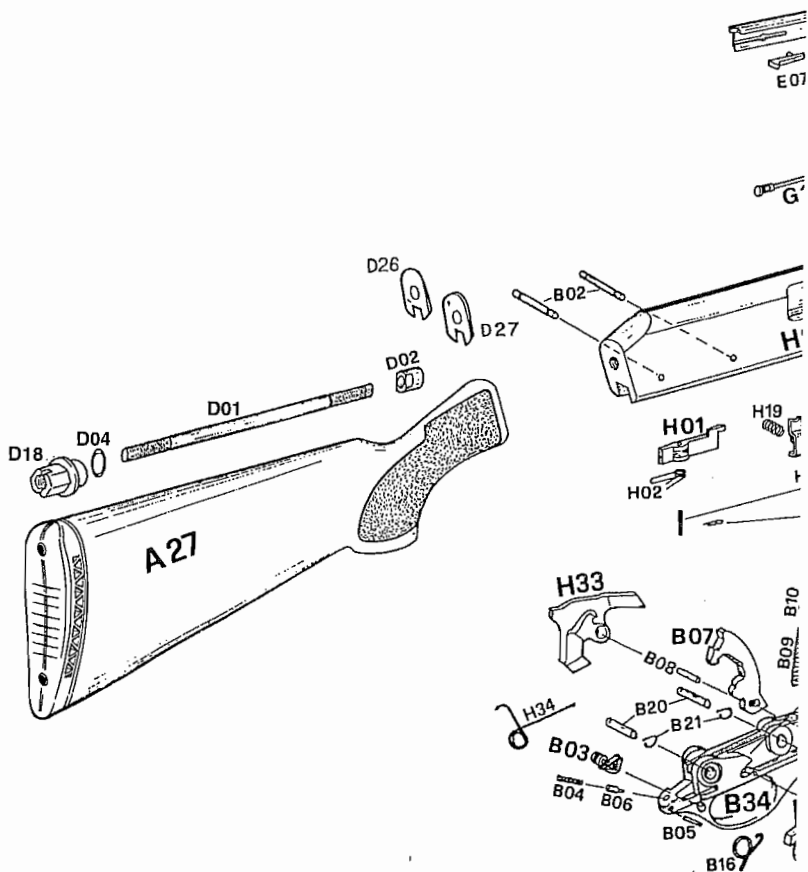

Fabarm Part #	HK Part #	Description	Fabarm Part #	HK Part #	Description
A27	A2700	pump plastic stock	B21	B2100	trigger guard pin spring
A27C	A27C0	camouflaged pump plastic stock	B22	B2200	carrier dog
B02	B0200	trigger guard retaining pin	B23	B2300	carrier dog pin
B03	B0300	hand safety button	B33	B3300	carrier
B04	B0400	hand safety spring	B34	B3400	trigger guard
B05	B0500	hand safety spring pin	C70	C7000	long forend
B06	B0600	hand safety spring plunger	C70C	C70C0	camouflaged long forend
B07	B0700	hammer	C72	C7200	elastic forend pin
B08	B0800	hammer pin	D01	D0100	stock connecting rod
B09	B0900	hammer spring	D02	D0200	stock bolt cap
B10	B1000	hammer spring follower	D04	D0400	stock washer
B11	B1100	sear	D18	D1800	stock & balance retaining screw
B12	B1200	sear spring	D26	D2600	drop spacer -5mm
B13	B1300	sear spring follower	D27	D2700	drop spacer +5mm
B14	B1400	trigger and sear pin	E07	E0700	ejector
B15	B1500	trigger	F02	F0200	magazine lube washer
B16	B1600	trigger spring	F03	F0300	magazine follower
B18	B1800	carrier spring	F27	F2700	forend cap
B19	B1900	carrier spring guide	F32	F3200	magazine spring
B20	B2000	trigger guard pin bushing	F38	F3800	magazine spring retaining ring

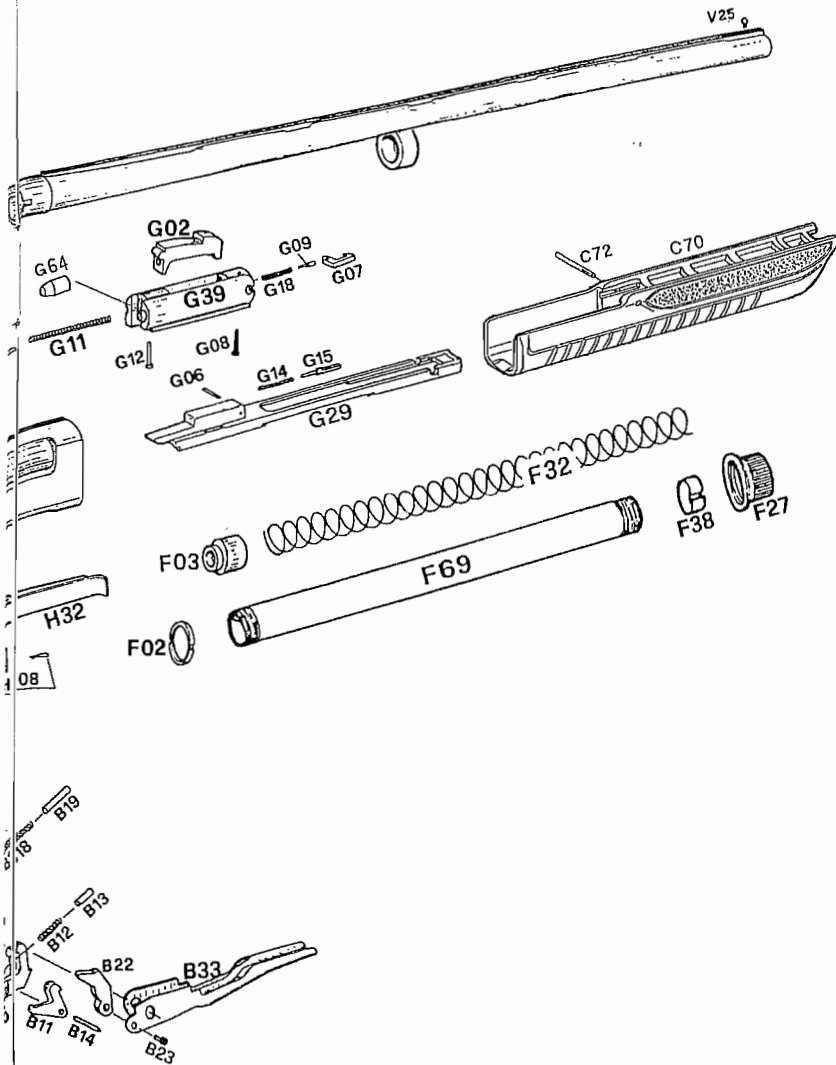

Fabarm Part #	HK Part #	Description
F69	F6900	magazine tube
G02	G0200	locking bolt
G06	G0600	cocking handle plunger pin
G07	G0700	extractor
G08	G0800	extractor retaining pin
G09	G0900	extractor plunger
G10	G1000	firing pin
G11	G1100	firing pin spring
G12	G1200	firing pin stop
G1	G1400	bolt slide spring
G15	G1500	bolt slide spring
G18	G1800	extractor spring
G29	G2900	action bar
G39	G3900	breech bolt for pump
G64	G6400	breech bolt absorber
H01	H0100	magazine shell latch
H02	H0200	magazine shell latch spring

Fabarm Part #	HK Part #	Description
H07	H0700	latch pin
H08	H0800	latch pin spring
H19	H1900	carrier latch spring
H32	H3200	cartridge retaining latch
H33	H3300	slide unhooking lever (forearm release button)
H34	H3400	slide unhooking lever spring
H61	H6100	receiver for pump
H61C	H61C0	camouflaged receiver for pump
V25	V2500	brass sight
	J2400S	24-inch slug barrel

NOTE: Not all parts depicted in diagram

Notes



Remember, firearms safety begins with you. Read and follow all safety information in the operators manual. Store all firearms in a safe and secure location. Keep firearms away from children. Always be a safe shooter.

HECKLER & KOCH, INC.
21480 Pacific Blvd.
Sterling, Virginia 20166-8903
United States of America
Tel. (703) 450-1900
Fax (703) 450-8160
www.hecklerkoch-usa.com