

**IVER
JOHNSON**



U.S. CARBINE .22

MODEL: EW.22HBA

Caliber: .22 long rifle

Please specify on order parts number and name.

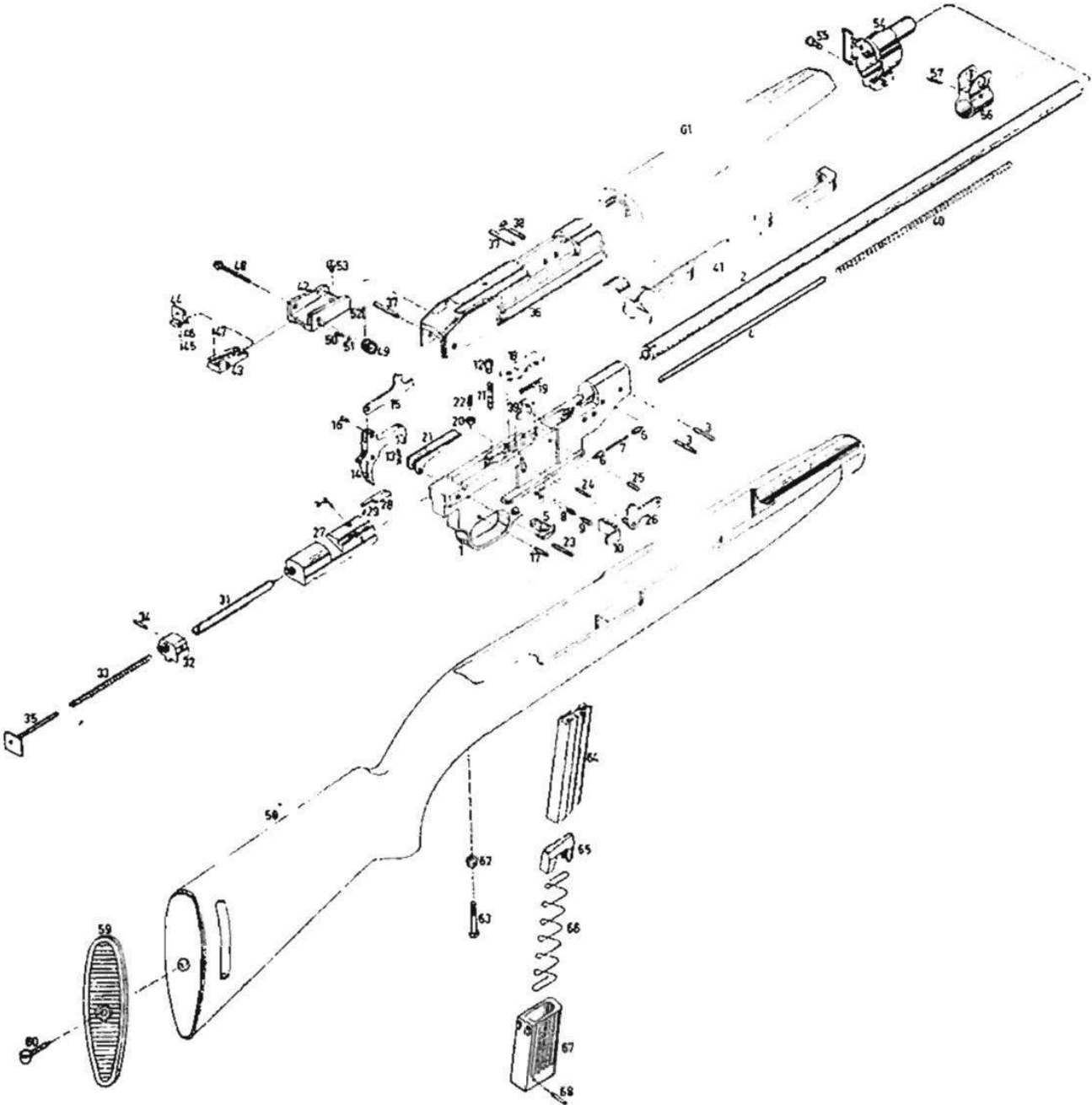

**Cat. Spare
No. Parts**

- 1 Trigger housing
- 2 Barrel
- 3 Barrel pin (2)
- 4 Operating slide
spring guide
- 5 Safety lever
- 6 Safety detent plunger (2)
- 7 Safety detent plunger spring
- 8 Magazine catch spring
- 9 Magazine catch
spring plunger
- 10 Magazine catch
- 11 Trigger bar spring
- 12 Trigger bar spring plunger
- 13 Trigger spring
- 14a Trigger assembly
- 14 Trigger
- 15 Trigger bar
- 16 Trigger bar pin
- 17 Trigger pin
- 18 Sear release plate
- 19 Sear release plate spring
- 20 Sear spring plunger
- 21 Sear
- 22 Sear spring
- 23 Sear holding pin
- 24 Sear release plate pin
- 25 Sear release pin
- 26 Sear release
- 27a Bolt assembly
- 27 Bolt
- 28 Extractor
- 29 Extractor spring
- 30 Extractor pin
- 31 Firing pin
- 32 Firing pin piece
- 33 Firing pin spring
- 34 Firing pin piece pin
- 35 Recoil plate
- 36 Receiver
- 37 Trigger housing
retaining pin (2)
- 38 Receiver screw
- 39 Ejector

**Cat. Spare
No. Parts**

- 40 Operating slide spring
- 41 Operating slide
- 42a Rear sight assembly
- 42 Rear sight base
- 43 Rear sight ramp
- 44 Rear sight sliding
aperture
- 45 Rear sight sliding spring
- 46 Rear sight sliding ball
- 47 Rear sight ramp pin
- 48 Rear sight windage screw
- 49 Rear sight windage knob
- 50 Windage stop spring
- 51 Windage stop ball
- 52 Windage stop pin
- 53 Rear sight base screw
- 54 Front band assembly
- 55 Front band screw
- 56 Front sight assembly
- 57 Front sight pin
- 58a Stock assembly
- 58 Stock (polished beech or
oiled walnut)
- 59 Butt plate
- 60 Butt plate screw
- 61 Handguard assembly
- 62 Rear guard screw plunger
- 63 Rear guard screw
- 64a Magazine assembly
- 64 Magazine tube
- 65 Magazine follower
- 66 Magazine spring
- 67 Magazine tube holder
- 68 Magazine tube holder pin

1. **GENERAL DIRECTIONS.** The EW.22HBA is a semi-automatic rifle operating on the blow back principle.
2. **OPERATING INSTRUCTIONS FOR EW.22HBA.** After checking to see that the chamber is empty by opening the action and pulling the operating slide handle (41) on the right side of the receiver to the rear. Depress the magazine catch (10) and remove the magazine from the rifle. Load the magazine with cartridges (see technical data), by depressing the magazine follower with the proper round of ammunition. The round should be placed forward of feed lips on the magazine, pressed down and to the rear under the feed lips. Each successive round should be inserted in the same manner until the proper capacity is reached. Point safety lever (5) to the white dot.

Insert the loaded magazine into the well in the magazine plate, while keeping the muzzle pointed in a safe direction. Push the magazine in until it snaps in place. If the catch does not engage check for dirt or debris that would prevent the magazine from catching.

With the muzzle of the rifle pointed in a safe direction pull the operating slide handle to the rear and allow the bolt to close using its own spring power.

To fire move the safety lever to the direction of the red dot.

SAFETY WARNING: Due to the necessity of putting the safety on manually, you must exercise caution in handling to prevent accidental discharge. **KEEP THE MUZZLE POINTED IN A SAFE DIRECTION AT ALL TIMES.** Do not load the rifle until you are ready to use it. Unload the rifle immediately after use. Never leave loaded rifle unattended.

3. **DISASSEMBLY PROCEDURE.** With the magazine removed and the chamber empty disassemble as follows: Loosen front band screw (55), remove rear guard screw (63), slip front band (54) forward on barrel, and lift wooden handguard (61) free. Separate barrel and receiver assembly from stock. Push both trigger housing retaining pins (37) out of receiver and remove receiver screw (38). Lift receiver (36) free (push downwards with finger tip the bolt). Pull operating slide (41), operating slide spring (40), and operating slide spring guide (4) forward. Raise recoil plate (35) and remove to rear firing pin spring (33), firing pin piece (31a) together with bolt. Further disassembly is not recommended. Reassemble in reverse order.

Safety Precautions:

Always carry the firearm with the safety on. Make sure that after shooting, the firearm is empty and that no cartridge is left in the barrel or magazine. Never point the firearm at anything you don't intend to shoot. ANY FIREARM IS DANGEROUS IF NOT CAREFULLY AND SAFELY HANDLED.

Technical data:

1. Grooved receiver for telescope mounts when rear sight removed.
2. Adjustable rear sight.
3. Every firearm factory test-fired.

Caliber	.22 long rifle
Overall length:	35½"
Barrel length	18"
Weight:	5.6 lbs.
Magazine capacity:	10 shots, 15 shot magazine available as option



2202 REDMOND ROAD
JACKSONVILLE, AR 72076
(501) 982-9491