

MOSQUITO

SIGSAUER



***Handling and
Safety Instructions***

Table of contents

1	General instructions	2	10	Service and repairs	21
2	Safety regulations	3	10.1	Fault detection, fault removal	21
2.1	Safety indications	4	10.2	Safekeeping and storage of pistol	23
3	Product description	6	10.3	Shipping the pistol	23
3.1	Main parts	6	11	Scope of supply	24
3.2	Technical data	6	11.1	Standard version	24
4	Transporting the pistol	7	11.2	Sport version	24
5	Safety mechanisms	7	11.3	Silencer version	24
5.1	Safety	7	11.4	Conversion set Sport version	24
5.2	Child safety	7	11.5	Conversion set Silencer version	24
5.3	Drop safety	8	12	Accessories	24
5.4	Magazine safety	8	13	Disposal	24
6	Handling the pistol	8	14	List of replacement parts	24
6.1	General	8			
6.2	Ammunition	8			
6.3	Loading the magazine	9			
6.4	Loading the pistol (ready for firing)	10			
6.5	Firing	11			
6.6	Reloading during firing	12			
6.7	Unloading the pistol; magazine not empty	12			
6.8	Unloading the pistol; magazine empty, slide open	13			
7	Conversion	14			
7.1	Conversion to Standard version	14			
7.1.1	Removing the counterweight	14			
7.1.2	Installing the counterweight	14			
7.2	Conversion to Standard version	15			
7.2.1	Removing the threaded cap	15			
7.2.2	Installing the threaded cap	15			
7.3	Exchanging the barrel	15			
8	Sight correction	16			
8.1	Sight correction for windage	16			
8.1.1	Rear sight adjustment	16			
8.2	Sight correction for elevation	16			
9	Pistol maintenance	17			
9.1	Stripping the pistol	17			
9.2	Cleaning the pistol	18			
9.3	Pistol assembly	19			
9.4	Functional check	20			
9.5	Care of the pistol	21			

1 General instructions

Be sure to read through these instructions carefully before any manipulation on this SIG SAUER pistol.

Understanding these instructions and the technically correct implementation of the information contained therein are **imperative** to correct preparation and safety during handling, maintenance and care of this SIG SAUER pistol. Do not use the pistol until you have fully understood all safety instructions and its handling procedures. Should you require further information, do not hesitate to contact your dealer, importer or the manufacturer.

Please observe the local and national legislation governing the ownership, carrying and use of firearms.

Be aware that these pistols, like all firearms, are dangerous. The pistol accompanying these Handling and Safety Instructions has been sold under the express understanding that the manufacturer and the importer of the pistol decline any responsibility for consequences of manipulations on the pistol or use of the pistol. This applies in particular to liability for bodily harm or damage to property resulting in part or in whole to:

- use with criminal intent or negligent use,
- improper or careless handling,
- defective, incorrect, hand-loaded or reloaded ammunition,
- inadequate care of the pistol (e.g. corrosion, damage),
- disregard of malfunctions,
- resale in contradiction of regional legislation and regulations,
- other circumstances beyond our direct and immediate control.

These limitation apply regardless of whether liability is asserted on the basis of contract, negligence or strict liability (including any failure to warn).

The manufacturer and the importers are not liable for incidental or consequential damages such as



loss of use of property, commercial loss or loss of earnings and profits.

2 Safety regulations

- Never use the pistol under the influence of drugs or alcohol, while ill or suffering other such difficulties. These conditions can impair your powers of judgment and reflexes.
- Always think of the pistol as being loaded and with the safety off until you have established the opposite through the unloading procedure.
- Always keep the muzzle of the pistol in a safe direction with all handling. A safe direction is towards an area where there are no people, other life forms or property that is not a recognized target.
- Never point the pistol at doors, panes of glass, walls, concrete, stone or flat surfaces (water included). A bullet can penetrate such surfaces or be ricocheted in an unsafe direction.
- Never aim at yourself or other life forms.
- Never rely on safety mechanisms alone. Safety mechanisms are not a substitute for careful, correct and secure handling of the pistol.
- Always treat your pistol as if the safety mechanisms were not functioning. The best safety precaution is a correct, well-trained and safe handling of the pistol.
- Never shoot with a pistol which has been penetrated by water, sand, dirt or other foreign bodies.
- Never decock the hammer by holding on to the hammer and pulling the trigger at the same time.
- Never let a loaded pistol out of your hand.
- Always unload the pistol immediately after firing, before putting the pistol away, putting into a holster or handing it to another authorized person.
- Never give the pistol to a person who has not thoroughly familiarized himself or herself with the safety instructions and handling of the pistol, by reading the corresponding instructions.
- Never leave the pistol lying unattended. Unauthorized persons could cause damage with it, threaten or kill other people, for which you could be held liable.
- Never store the pistol loaded, but remove the magazine and verify that there is no cartridge left in the chamber of the barrel by following the unloading procedure.
- Always keep the pistol and the ammunition separate from one another, and ensure that neither is obtained by unauthorized persons or children.

2.1 Safety indications

In the individual sections of these instructions, the following safety indications alert you to risks:

	WARNING!
Information on dangers, which if not scrupulously observed, can lead to severe bodily harm or death.	
	CAUTION!
Information on dangers, which if not scrupulously observed, can lead to bodily harm, damage to property and damage to the pistol.	
	CAUTION!
Information on technical requirements, which if not scrupulously observed, can lead to damage to the pistol.	

- Each of these safety indications consists of:
 - a headline with a signal word, a signal pictorial and a corresponding colour code
 - a description of the danger type and source
 - a description of possible consequences if the safety indications message is ignored
 - a description of actions or regulations for danger prevention

Product description



Fig. 1, Standard version



Fig. 2, Sport version



Fig. 3, Silencer version

3 Product description

3.1 Main parts

Item	Description	Item	Description
1	Barrel block	29	Hammer
4	Slide	40	Decocking lever
5	Front sight A, B, C	43	Magazine catch
6	Rear sight	46	Manual safety
15	Frame	51	Magazine
16	Takedown lever	77	Counterweight ^a
18	Slide catch lever	78	Cap ^a
20	Trigger	81	Threaded cap ^b

a. only Sport version
b. only Silencer version

3.2 Technical data

Technical data	Standard version	Sport version	Silencer version
Calibre	.22 Long Rifle	.22 Long Rifle	.22 Long Rifle
Overall length	183 mm	207 mm	207 mm
Overall height	134 mm	134 mm	134 mm
Overall width	37 mm	37 mm	37 mm
Barrel length	101 mm	126 mm	126 mm
Rifling length	406 mm, right	406 mm, right	406 mm, right
Number of grooves	6	6	6
Sight base	140 mm	164 mm	140 mm
Weight without magazine	650 g	740 g	650 g
Magazine weight, empty	50 g	50 g	50 g
Trigger pool, approx.	SA 18 N DA 55 N	SA 18 N DA 55 N	SA 18 N DA 55 N
Magazine capacity/rounds	10	10	10

Subject to change without notice

4 Transporting the pistol

	WARNING!
<p>Uncontrolled discharge of shot May lead to death or severe injuries</p> <ul style="list-style-type: none"> • For your own safety and the safety of others, always transport the pistol unloaded (see section 6.7 and 6.8), decocked and closed. • Never carry a pistol with you that has already been cocked and which has a round in the chamber. • Always carry the pistol so that if you fall or slip, you always have the direction of the muzzle under control. • Transport the pistol separate from the ammunition. • The pistol and ammunition must not be accessible to children and other inexperienced or unauthorised persons. • Ensure that all applicable laws governing the transport of firearms are complied with. 	

5 Safety mechanisms

	WARNING!
<p>Uncontrolled shot discharge Possibly death or serious injuries</p> <ul style="list-style-type: none"> • Never on safety mechanisms alone. Safety mechanisms are not a substitute for careful, correct and secure handling of the pistol. 	

5.1 Safety

- Push the safety **46** down to secure the firing pin (see Fig. 6 on page 13).

5.2 Child safety

Securing: (see Fig. 5, on page 8)

	WARNING!
<p>Uncontrolled shot discharge Possibly death or serious injuries</p> <ul style="list-style-type: none"> • Hammer must be decocked when bolting. 	

1. Insert key into opening at rear of the magazine well/shaft (striker surface is flush with the grip plate and horizontal with the magazine well/shaft), push in and turn by 90° (striker remains in sunk position and is vertical with the magazine shaft).

Releasing: (see Fig. 4, left/right)

	WARNING!
<p>Uncontrolled shot discharge Possibly death or serious injuries</p> <ul style="list-style-type: none"> • Pistol must be decocked. 	

1. Proceed in the reverse order to securing.



Fig. 4, decocked

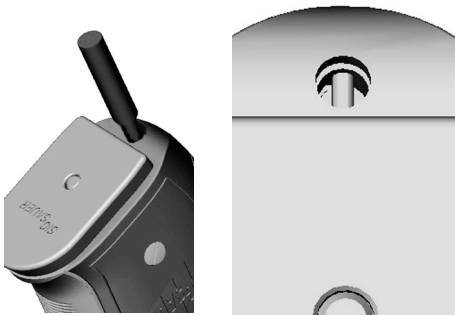

Fig. 5, secured

5.3 Drop safety

Safety lock is in front of the firing pin and prevents the firing pin from hitting the round. Only when the trigger pulls the recoil spring bar does the safety lever push the safety lock up and release the firing pin.

5.4 Magazine safety

Magazine safety prevents the trigger from being pushed through. Only when the magazine is pushed into the magazine well/shaft and is clicked home is the safety disengaged and the trigger is released.

6 Handling the pistol

6.1 General

The pistol is generally delivered preserved with a thin, protective grease and oil coating and must be stripped before being used for the first time, protective oil or grease removed and lubricated again. "First use" (see section 9).

Procedure:

1. Strip pistol (see section 9.1).
2. Clean and relubricate pistol (see section 9.2).
3. Assemble pistol (see section 9.3).

6.2 Ammunition



WARNING!

Inadmissible ammunition

Possibly death or serious injuries and damage to the pistol

- For your pistol, use only commercial grade ammunition in its original packing for which corresponds with the calibre of the pistol. The correct calibre is imprinted on the pistol .22 Long Rifle.
- Never use reloaded, "refurbished", hand-loaded, non-standard ammunition or ammunition of a different calibre.
- Never use dirty, wet, corroded, bent, damaged or oiled ammunition.
- Never leave the ammunition lying unattended.

Information:

The .22 LR ammunition spectrum ranges from very light loads for single loader guns to sport load, utility load and on through to high speed rounds. Unfortunately, however, it is not possible to adjust a semi-automatic gun to all loads.

We have therefore decided to make an adjustment to the loads that have priority for use with the MOSQUITO, which are the two major groups, utility and high-speed rounds. So to increase the round compatibility, we provide two slide springs for every pistol. The bigger bored version is designed for high-speed loads and is fitted in the pistol with delivery. The simple coiled smaller spring (marked white) is for standard loads and is supplied with the pistol.

Tip:

It has been proven that many types of utility rounds function more smoothly if the rounds are lightly oiled.

	WARNING!
Uncontrolled shot discharge Possibly death or serious injuries	
<ul style="list-style-type: none">• Never oil high-speed rounds, as the pistol can unbolt too quickly while shooting.	

6.3 Loading the magazine

Procedure:

1. Place load on feeder close to the magazine lips.
2. Push the side lock on the magazine down.
3. Only load the number of rounds that are to be shot (max.10 rounds).

The number of inserted rounds can be determined through the slot on the magazine.

6.4 Loading the pistol (ready for firing)

**WARNING!**

Lacking in awareness of potential dangers
Possibly death or serious injuries

- Never load or unload the pistol inside a vehicle, inside a building or any other enclosed space (except in a designated firing range).
- Before loading always wipe off any excess grease and oil and check to see if there are any foreign objects/ material in the barrel.
- Always keep the muzzle of the pistol pointed in a safe direction.
- Do not put your finger on the trigger. Keep your finger outside the trigger guard.
- Only insert the loaded magazine immediately before firing.
- Never pull the hammer back by hand, but rather with the slide to cock it so that unintentional firing is prevented.
- Never rely on the safety mechanisms alone. Safety mechanisms are not a substitute for careful and proper handling of the pistol.
- Never let a loaded pistol out of your hand.

Procedure:

1. Point pistol in a safe direction.
2. Insert full magazine and ensure that it is fully engaged.
3. Pull slide back fully and release.
 - The pistol is loaded and ready for firing with the single action trigger.
 - The pistol can now be decocked using the decocking lever. It is then loaded, decocked and ready for firing with the double action trigger.
 - The pistol is decocked and ready for firing.

6.5 Firing

**WARNING!**

Lacking in awareness of potential dangers
Possibly death or serious injuries

- Ensure that the target and surroundings allow shots to be fired without danger.
- Be certain when firing that your fingers, hands or other parts of the body are not in front of, above or beside the barrel muzzle or the ejector port.
- Never allow a third person to stand next to you where they could be hit by ejected cartridge cases.
- When shooting, always wear ear protection and protective eye glasses. Inform other people close to you about the need to wear ear protection.
- Interrupt shooting immediately and unload the pistol if you suspect that a round is not inserted correctly, a case is jammed, a round may have blocked the barrel or a shot sounds or gives the sensation that it may be “weak” or unusual.
- Never try to dislodge a blockage by firing another round.

Procedure:

1. Aim pistol at a safe target.
2. Place finger on trigger and squeeze the trigger (activates firing).
3. Keep the pistol aimed at the target and fire further shots as required.
4. Remove magazine and unload pistol. If the magazine has been shot empty, the slide remains in the open position. Reload pistol if further shots are to be fired.

**WARNING!**

Pistol is ready to fire
Possibly death or serious injuries

- Double action/single action pistols are in a cocked and ready to fire status after each firing.
- If you want to interrupt shooting, you must action the decocking lever to lower the hammer. The pistol is then in the loaded, decocked and ready to fire status.
- Once you decide to stop shooting immediately unload the pistol.

6.6 Reloading during firing

The slide is held in the open position.



WARNING!

**Lacking in awareness of potential dangers
Possibly death or serious injuries**

- Never let the pistol out of your hand.
- Keep the pistol aimed at the safe target.

Procedure:

1. Remove the empty magazine.
2. Insert full magazine and ensure that it is fully engaged.
3. Push slide catch lever down or pull slide back until stop and allow to fly forward.
 - The pistol is loaded and ready to fire.
 - The pistol can also be decocked using the decocking lever.
 - The pistol is now loaded, decocked and ready to fire.

6.7 Unloading the pistol; magazine not empty



WARNING!

**Pistol is ready to fire
Possibly death or serious injuries**

- Never let the pistol out of your hand before it is unloaded.
- The pistol is loaded; a round is in the chamber.
- Perform the unloading action with only two fingers from the rear.
- Never place your hand over the slide opening.

Procedure:

1. Keep the pistol muzzle pointed in a safe direction.
 2. Press the decocking lever; the hammer is held in the safety notch.
 3. Press magazine catch and remove magazine.
 4. Pull slide back until stop and push slide stop lever down. The round is ejected and the slide is held in the opened position.
 5. Check (visually and manually with appropriate aid) to ensure that the round has been ejected and that there is no round in the chamber (see Fig. 6).
 6. Press slide catch lever. The slide closes.
 7. Push decocking lever down.
 8. Empty magazine.
 9. Pick up ejected round and clean pistol.
- The pistol is unloaded and decocked.



WARNING!

Not properly cleaned pistol
Possibly death or serious injuries, damage to the pistol

- The pistol must be cleaned after each firing. (see section 9.2).

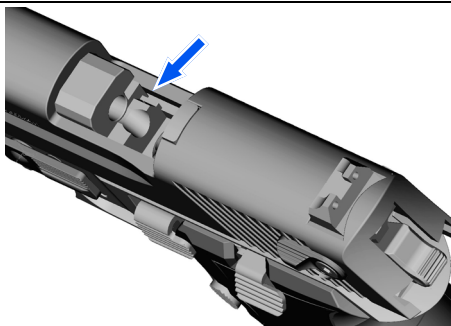

Fig. 6

6.8 Unloading the pistol; magazine empty, slide open



WARNING!

Pistol is loaded
Possibly death or serious injuries

- You must not let the pistol out of your hand until the magazine has been removed and the pistol is unloaded.

Procedure:

1. Keep the pistol muzzle pointed in a safe direction.
2. Press magazine catch and remove magazine.
3. Check (visually and manually with appropriate aid) to ensure that there is no round in the chamber (see Fig. 6).
4. Press slide catch lever. The slide closes.
5. Push decocking lever down.

The pistol is unloaded and decocked.

7 Conversion

7.1 Conversion to Standard version

Procedure:

- 1. Remove the front sight **5** and insert the cap **78** into the notch of the slide.
- 2. Disassemble the pistol (see chapter 9.1).
- 3. Exchange the barrel of the Standard version **1a** with the barrel of the Sport version **1b** (see chapter 7.3).
- 4. Reassemble the pistol (see chapter 9.3).
- 5. Install the counterweight **77** (see chapter 7.1.2).
- 6. Insert the front sight **5** into the notch of the counterweight.

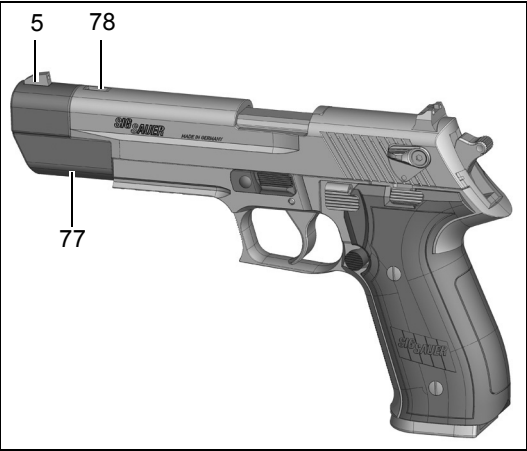

Fig. 7, Sport version

- 7. Sight correction (see chapter 8).

7.1.1 Removing the counterweight

Procedure:

- 1. Release the threaded pin **79** using the allen wrench **80** and remove it (see Fig. 8).
- 2. Remove the counterweight **77**.

7.1.2 Installing the counterweight

Procedure:

- 1. Attach the counterweight **77**.

	CAUTION!
Possible damage to the pistol	
<ul style="list-style-type: none">• Do not tighten the threaded pin too tight.	
2. Fix the counterweight with the threaded pin 79 . For this use the allen wrench 80 provided.	

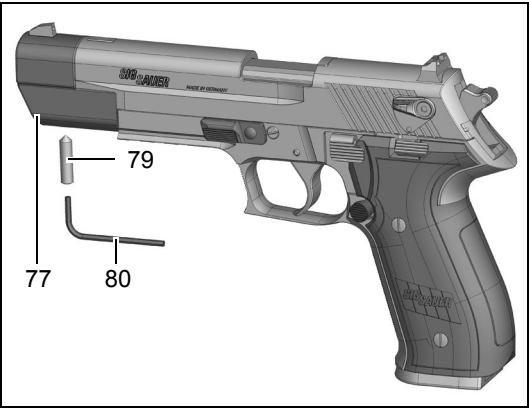

Fig. 8

7.2 Conversion to Standard version

Procedure:

1. Disassemble the pistol (see chapter 9.1).
2. Exchange the barrel of the Standard version **1a** with the barrel of the Silencer version **1c** (see chapter 7.3).
3. Reassemble the pistol (see chapter 9.3).
4. Install the threaded cap **81** (see chapter 7.2.2).

7.2.1 Removing the threaded cap

Procedure:

1. Release the threaded cap **81** using the assembly wrench **82** provided and remove it.

7.2.2 Installing the threaded cap

1. Attach the threaded cap **81** and tighten it with the assembly wrench **82** provided.



Fig. 9

7.3 Exchanging the barrel

Procedure:

1. Release the screw **66** and remove the takedown lever **16**.
2. Release the screw **58** of the frame **15** and remove it.
3. Lift the barrel **1a** and take out the takedown lever insert **25**.

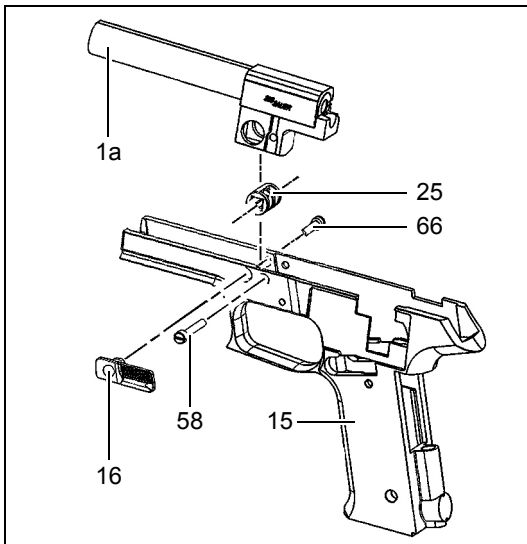

Fig. 10

4. Insert the takedown lever insert into the barrel **1b** (Sport version) or **1c** (Silencer version).
5. Insert the barrel into the frame.

CAUTION!

Possible damage to the pistol

- Do not tighten the screws too tight.

Notice:

Before inserting the screws **58** and **66** apply **Loctite** to the thread.

Sight correction

- Place the screw **58** in the frame and tighten it.
- Use screw **66** to fix the takedown lever **25** with the frame.

8 Sight correction

	CAUTION!
Possibly damage to the pistol	
<ul style="list-style-type: none">Any adjustment to sights should only be done on an unloaded pistol, by an armourer, gunsmith or other qualified person.	

8.1 Sight correction for windage

8.1.1 Rear sight adjustment

	CAUTION!
Possibly damage to the pistol when turning the adjusting screw clockwise	
<ul style="list-style-type: none">Turn the adjusting screw clockwise only until you notice a light resistance. Do not turn the screw any further!The rear sight must not exceed the edge shown in Fig. 12.	

Turning the lateral adjusting screw **clockwise** one full rotation moves the point of impact approximately 8 cm **to the left** at a distance of 25 m.

Turning the lateral adjusting screw **counter clockwise** one full rotation moves the point of impact approximately 8 cm **to the right** at a distance of 25 m.

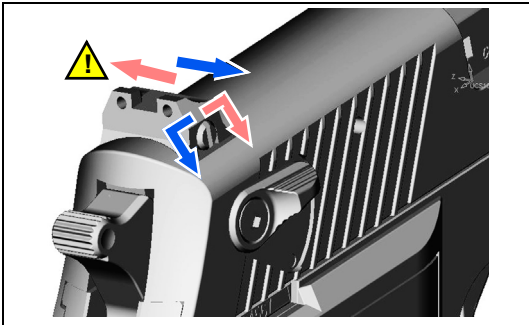

Fig. 11

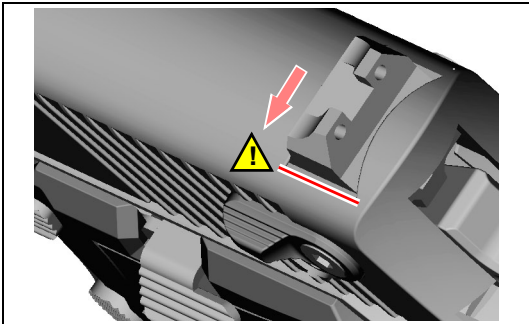



Fig. 12

8.2 Sight correction for elevation

Changing to the **higher front sight lowers** the **point of impact** approximately 20 cm at 25 m.

Changing to the **lower front sight raises** the **point of impact** approximately 20 cm at 25 m.

9 Pistol maintenance



WARNING!

Pistol is ready to fire
Possibly death or serious injuries

- Magazine must be removed from the pistol.
- Before field stripping your pistol for cleaning, verify again that it is not loaded.
- Do not put your fingers into the slide.

9.1 Stripping the pistol

Procedure:

1. Unload pistol (see sections 6.7 and 6.8).
2. Remove the threaded cap of the Silencer version (see chapter 7.2.1), resp. the counterweight of the Sport version (see chapter 7.1.1).
3. Retract slide **4** fully and lock open by engaging the slide catch lever **18** (see Fig. 13).

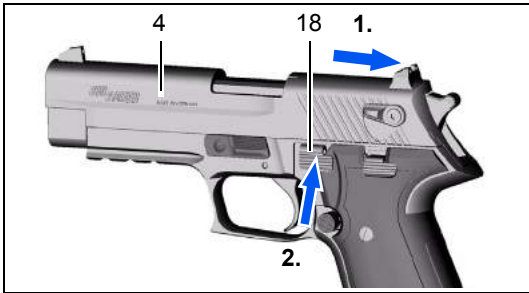

Fig. 13

4. Check to ensure there is no round in the chamber.
5. Depress slide catch lever to close slide.
6. Rotate take down lever **16** clockwise 180° until it points forward (see Fig. 14).

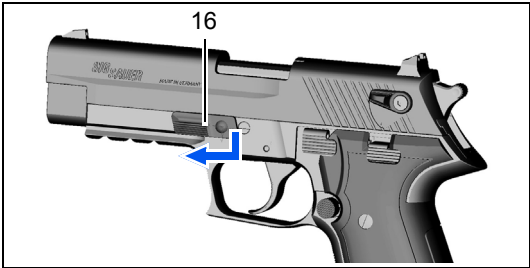

Fig. 14

7. Retract slide fully; lift rear of slide until clear of frame and slowly move slide group forward towards muzzle end of pistol (see Fig. 15 and Fig. 16).



Fig. 15



Fig. 16

8. Remove slide assembly (slide, recoil spring guide and recoil spring) from the barrel muzzle.

This level of stripping is sufficient for a thorough cleaning after firing.

	CAUTION!
Possibly damage to the pistol	
<ul style="list-style-type: none">Further dismantling of the pistol may only be carried out by qualified armourers and gunsmiths.	

9.2 Cleaning the pistol

	CAUTION!
Possibly damage to the pistol	
<ul style="list-style-type: none">Never clean the barrel from the front (muzzle end) and never use steel brushes, as these can damage the smooth surface of the barrel. Use a suitable cleaning rod and brush designed for .22 calibre.Solvents can damage the surface of the pistol. Before using a cleaning or solvent agent, take note of the instructions and warnings provided by the manufacturer.	

Procedure:

1. Moisten cleaning brushes with gun oil and insert into the barrel through the chamber. Carefully remove all powder residues and dirt in the barrel and chamber with the cleaning brush.
2. Free the insides of the barrel bore and chamber of powder residues and oil using cleaning cloth. We recommend the use of original SIG SAUER gun oil.
3. Clean external surfaces of the barrel with a brush that has been moistened with gun oil.
4. Wipe off frame, slide, spring guide and recoil spring guides with a cloth soaked in gun oil or grease.
5. Lightly oil barrel bore and chamber.

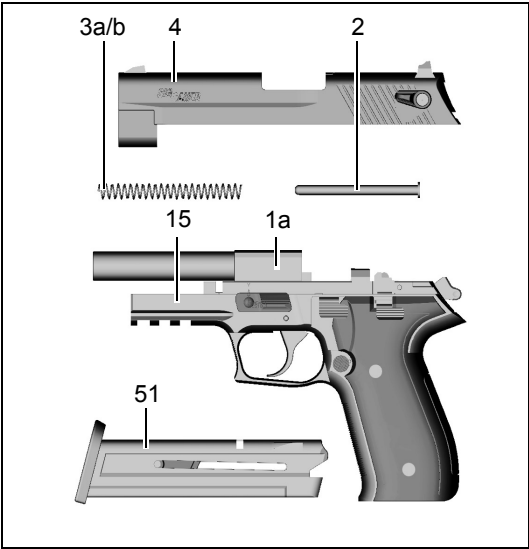

Fig. 17, Cleaning Standard version

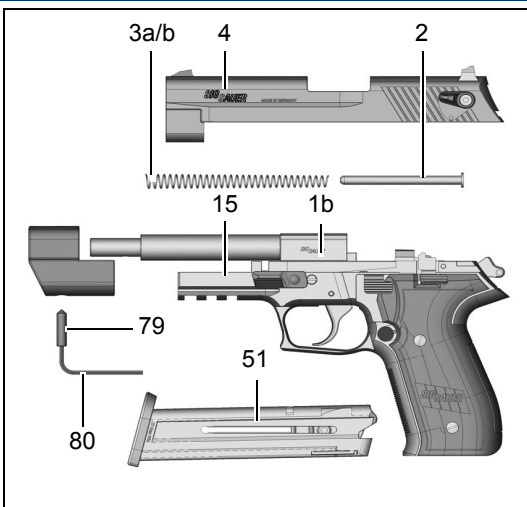

Fig. 18, Cleaning Sport version

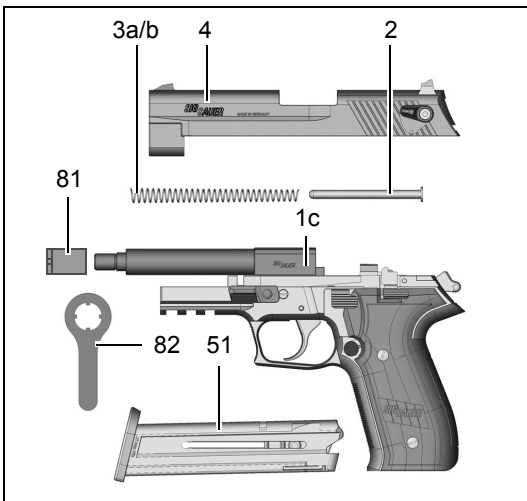

Fig. 19, Cleaning Silencer version

9.3 Pistol assembly

Procedure:

1. Check there is no foreign matter inside the pistol.
2. Slide recoil spring **3** onto the spring guide **2**.
3. Insert spring guide with recoil spring into the frame **15**.



CAUTION!

Slide, recoil spring guide and recoil spring are loosely connected

Possibly damage to the pistol and bodily harm

- Careful handling of the slide and the parts connected to the recoil spring.

4. Slip slide over the spring guide and pull back until the slide guide can click into the frame guide.
5. Pull slide forward in the guide until the slide is in the locked position.
6. Install the threaded cap of the Silencer version (see chapter 7.2.2), resp. the counterweight of the Sport version (see chapter 7.1.2).
7. Turn take down lever by 180° until it points back.

Note:

The pistol is unloaded and decocked.

9.4 Functional check

Note:

The check of all functions must be made on the assembled pistol:

- to determine any causes of malfunctioning,
- after completion of repairs,
- and after each cleaning and assembly of the pistol.

Procedure:

1. Remove the magazine and unload pistol (see section 6.7 and 6.8).
2. Check tension of the recoil spring and ease of running of the slide.
 - Pull slide back until stop and allow to fly forward.
 - Check that the slide flicks forward with energy and locks into place.
 - Repeat check again.
3. Check double action (DA).
 - Insert empty magazine (gun has a magazine safety).
 - Pull trigger with decocked hammer.
 - Check to see if the hammer is cocked and hits home hard at the end of the trigger path and is then held in the safety notch.
4. Check trigger path and trigger interruption.
 - Insert empty magazine (gun has a magazine safety).
 - With decocked hammer and pulled through trigger, pull slide back until stop and release.
 - Check that the hammer is held back in cocked position (trigger stays pulled back).
5. Check single action trigger function (SA).
 - Insert empty magazine (gun has a magazine safety).
 - Release trigger.
 - Check that trigger bar is engaged again and that the hammer is activated by pulling again.
6. Check decocking lever function and safety notch on the hammer.
 - Cock hammer and decock with decocking lever, without touching the trigger while doing so.
 - Check that the hammer is held in the safety notch before reaching the front end position and the trigger is left in the rest position.
7. Check slide stop lever.
 - Insert empty magazine; pull slide right back and release slide.
 - Check that the slide is held in the rear end position.
 - Press slide stop lever.
 - Check easy inserting of the magazine into frame.
 - Check fault-free clicking in and out of the magazine catch.
8. Check magazine.
 - Check state of the magazine tube (lips and floorplate) for signs of damage or dirt.
 - Check that magazine floorplate is properly secured.
 - Check easy running and spring action of the feeder.
 - Check easy inserting of the magazine into frame.
 - Check fault-free clicking in and out of the magazine catch.
9. Check external condition of the pistol.
 - Check front sight, rear sight, grip plates and take down lever for damage and dirt.
 - Check firm positioning of rear and front sight and grip plates.

9.5 Care of the pistol

**CAUTION!**

Neglecting the pistol
Possibly damage to the pistol and bodily harm

- Always keep your pistol clean and in good working order.
- Clean the pistol after 250 rounds, before every ammunition type change and after every use. The chamber in particular must be thoroughly cleaned.
- Never change or repair parts of your pistol yourself.
- Have your pistol checked once a year by a qualified gunsmith or armourer, as defects, wear and tear, corrosion etc. may not always be visible from the exterior.
- For repair or service work, however, we recommend that you send your pistol to the manufacturer. The manufacturer has a constant supply of replacement parts in stock.
- If you order replacement parts without returning the pistol, you are responsible for ordering the correct replacement part and its installation by a qualified gunsmith or armourer

10 Service and repairs

10.1 Fault detection, fault removal

Faults can be prevented with the proper maintenance of the pistol (cleaning and inspection). Should, however, a fault occur while firing, proceed as follows:

**WARNING!**

Uncontrolled shot discharge
Possibly death or serious injuries

- Keep the pistol pointed in a safe firing direction and remove your finger from the trigger while you carry out the steps shown below.

1. Remove the magazine and deposit safely.
2. Pull slide back until stop and hold the slide in the open position by pushing up the slide stop lever.
3. Check (visually and manually with appropriate aid) to ensure that there is no round, bullet, case or foreign bodies in the chamber or in the barrel bore. If a bullet is lodged in the barrel bore, strip the pistol and have the bullet removed by a qualified gunsmith using the proper tools.
4. Remove all rounds, cases or foreign bodies. Clean, grease and assemble pistol.
5. Have pistol checked by a gunsmith or armourer.

Part/fault	Possible cause of fault/defect	Possible fault/defect removal
Ammunition feeding: No round is fed in.	Magazine is not inserted correctly, deformed or dirty.	Insert magazine correctly or replace it.
	Pistol or rounds dirty or greased too much.	Strip, clean and lubricate pistol, clean or replace ammunition.
	Large (heavy) slide spring installed and standard ammunition used.	Small (light) slide spring mounted.
	Pistol defective.	Repair by manufacturer.
Slide: Slide does not close properly.	Pistol or rounds dirty or greased too much.	Strip, clean and lubricate pistol, clean or replace ammunition.
	Pistol defective.	Repair by manufacturer.
Case ejection: Empty case remains in the chamber or gets stuck in ejector port.	Underloaded ammunition.	Replace ammunition.
	Recoil not sufficient due to dirt.	Strip, clean and lubricate pistol.
	Pistol defective.	Repair by manufacturer.
Misfiring: Hammer hits; no discharge.	Firing pin sticks in the firing pin guide.	Strip, clean and lubricate pistol. Have pistol checked by armourer.
	Ammunition fault.	Manually cycle slide to load new round
	Pistol defective.	Repair by manufacturer.

10.2 Safekeeping and storage of pistol



WARNING!

Uncontrolled shot discharge Possibly death or serious injuries

- Only store your pistol unloaded and cleaned.
- Keep your pistol separate from ammunition and locked away. The pistol and ammunition must always be in a place inaccessible to children and unauthorized persons.

- To the Sauer & Sohn representative (importer) in your country
- If a local Sauer & Sohn specialist dealer or a Sauer & Sohn representative is not available in your country, send to the following address:

J.P. Sauer & Sohn GmbH, gegr. 1751
Sauerstraße 2-6
D-24340 Eckernförde
Germany
Phone: +49 4351 471 100
Fax: +49 4351 471 160
www.sigsauer.de

10.3 Shipping the pistol

Note:

- Familiarize yourself with all laws and regulations governing shipping and transport of firearms.
1. Check pistol to ensure it is unloaded and decocked.
 2. Pack the pistol well (if possible in the original packaging) to prevent damage during shipment. If returning in original case, cover the case with a second outer layer. Ammunition and accessories (other than magazines) should not be included in the package.
 3. Enclose a letter with the following information:
 - Your name
 - Your address
 - Your telephone number, at which you can be contacted during the day
 - A detailed description of the problems encountered or the work that is to be carried out.
 4. Send the pistol insured and postage paid (parcels with incorrect postage will not be accepted) to:
 - The point of sale where the firearm was purchased
 - The local Sauer & Sohn specialist dealer

11 Scope of supply

11.1 Standard version

- 1 Pistol
- 1 Magazine
- 1 Gun case
- 1 Safety & Handling booklet
- 1 Test group card
- 1 Cable lock
- 1 Dry fire plug
- 1 SIG SAUER gun oil
- 2 Exchangeable front sights
- 1 Recoil spring
- 1 Key (integral lock)

11.2 Sport version

As Standard version and additionally:

- 1 x Allen wrench

11.3 Silencer version

As Standard version and additionally:

- 1 x Assembly wrench

11.4 Conversion set Sport version

- 1 x Barrel Sport version
- 1 x Counterweight
- 1 x Cap
- 1 x Threaded pin
- 1 x Allen wrench

11.5 Conversion set Silencer version

- 1 x Barrel Silencer version
- 1 x Threaded cap
- 1 x Assembly wrench

12 Accessories

- Case locks
- SIG SAUER gun oil
- Leather holsters
- Kydex holsters
- X-POINT sights
- Mount for X-POINT sights

13 Disposal

- Comply with all regarding laws on disposal of handguns.
- Provided these do not contradict the above mentioned laws, the shipping of the pistol for disposal is recommended to one of the addresses named in the section “Shipping the pistol” (page 23).
- The provisions set out in the section “Shipping the pistol” (page 23) must be followed when shipping the pistol.

14 List of replacement parts

Required information when ordering replacement parts

- Pistol type (calibre, description of type)
- Pistol number
- Item number
- Part designation

List of replacement parts

Item Description

- 1a Barrel ^a
- 1b Barrel ^b
- 1c Barrel ^c
- 2 Recoil spring guide
- 3a Recoil spring, white (standard)
- 3b Recoil spring (high velocity)
- 4 Slide
- 5a Front sight A
- 5b Front sight B
- 5c Front sight C
- 6 Rear Sight
- 7 Slide breech block pin
- 8 Trigger bar spring
- 9 Breech block
- 10 Extractor
- 11 Firing pin
- 12 Firing pin spring
- 13 Safety lock
- 14 Safety lock spring
- 15 Frame
- 16 Takedown lever
- 17 Striker pin for integral safety lock
- 18 Slide catch lever
- 19 Slide catch lever spring
- 20 Trigger
- 21 Trigger pivot
- 22 Trigger bar
- 23 Lock
- 24 Sear
- 25 Takedown lever insert
- 27 Spring for integral safety lock
- 28 Safety lever
- 29 Hammer
- 30 Spring for safety lever

Item Description

- 31 Ball for safety lever
- 32 Ejector
- 33 Hammer strut
- 34 Mainspring
- 35 Action casing half (left)
- 36 Ball centering
- 37 Action casing half (right)
- 38 Extractor spring
- 39 Magazine safety
- 40 Decocking lever
- 41 Decocking lever bearing
- 42 Decocking lever spring
- 43 Magazine catch
- 44 Safety lever (Manual safety), right
- 45 Magazine catch spring
- 46 Safety lever (Manual safety), left
- 47 Feeder axle
- 48 Grip plate, right
- 49 Grip plate, left
- 50 Grip plate screws
- 51 Magazine tube
- 52 Magazine spring
- 53 Feeder
- 54 Magazine floor plate
- 55 Floorplate insert
- 56 Threaded socket for grip plates
- 57 Retainer
- 58 Screw for grip
- 59 Hammer reset spring
- 60 Hammer pivot pin
- 61 Hammer strut pin
- 62 Trigger bar pin
- 63 Spring for magazine safety

Item Description

- 64 Safety lever pin
- 65 Magazine safety pivot pin
- 66 Screw for decocking lever
- 67 Screw for safety lever
- 68 Adjusting screw
- 69 Key
- 70 Main spring washer
- 71 Main spring washer
- 72 Key ring
- 73 Extractor guide
- 74 Extractor pivot pin
- 75 Breech block pin
- 76 Breech block spring
- 77 Counterweight ^b
- 78 Cap ^b
- 79 Threaded pin ^b
- 80 Allen wrench ^b
- 81 Threaded cap ^c
- 82 Assembly wrench ^c

a. Standard version
b. Sport version
c. Silencer version

List of replacement parts

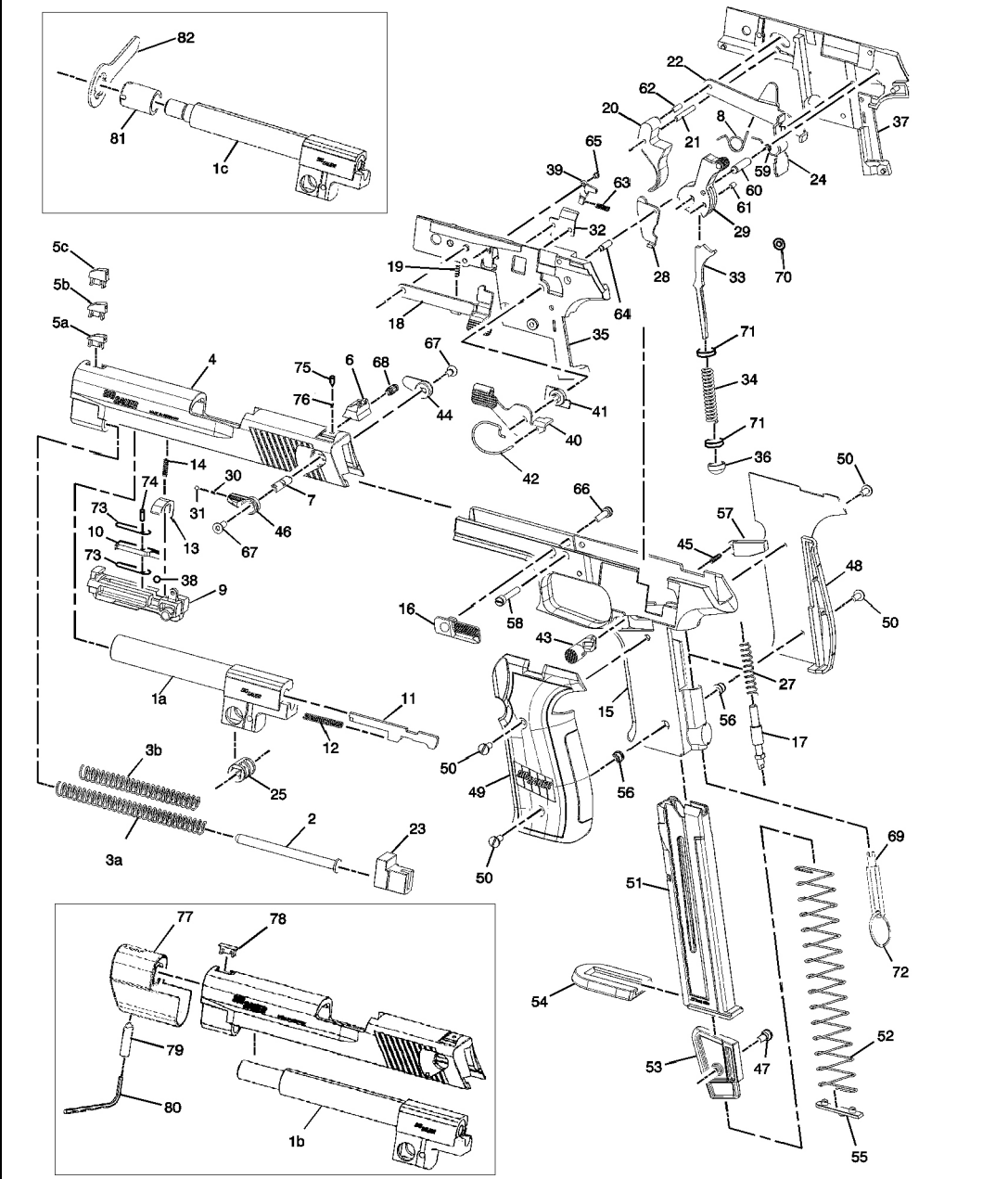

Fig. 20, Spare parts for MOSQUITO



SIGSAUER



SIGSAUER

J. P. Sauer & Sohn GmbH
gegr. 1751

Sauerstr. 2-6
D-24340 Eckernförde
Germany

Phone +49 4351 471 100
Fax +49 4351 471 160
www.sigsauer.de